

8 Install Mezzanine Card

- A** Hold mezzanine card by its edges and remove from packaging. Remove the protective connector cover from the mezzanine card.
- B** With a Phillips® screwdriver, remove the four screws on the server board.

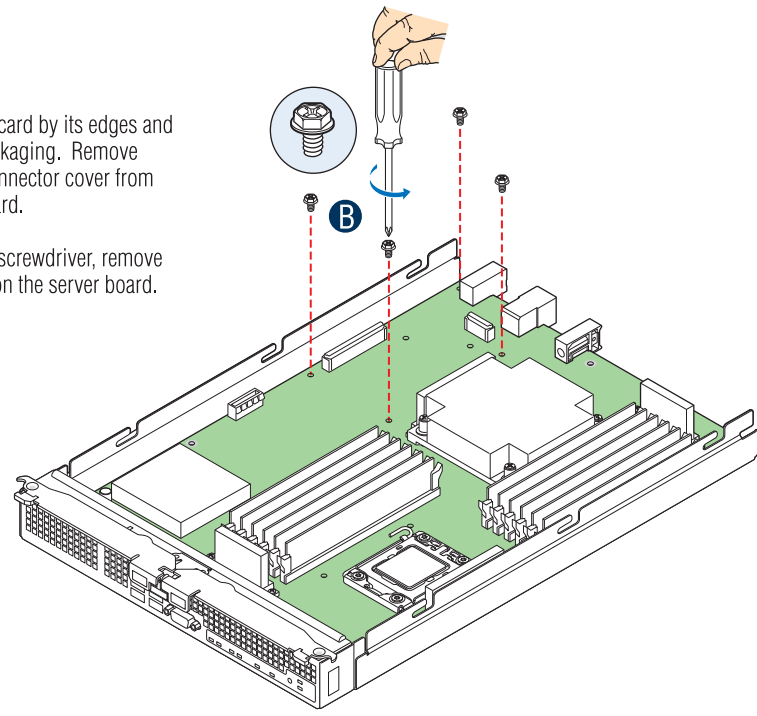

- C** With a 1/4-inch nut driver, install the four standoffs that shipped with the mezzanine card in the same holes that were just vacated by the screws.

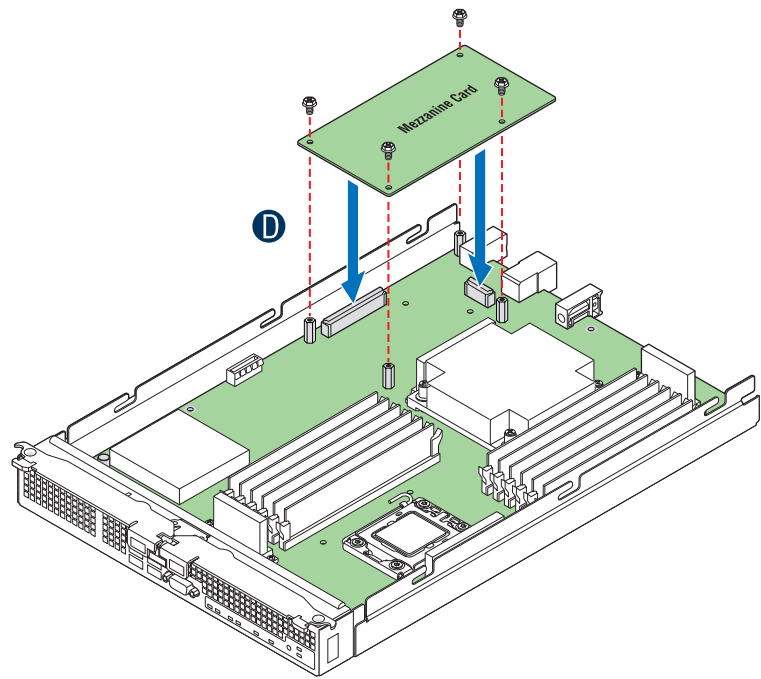
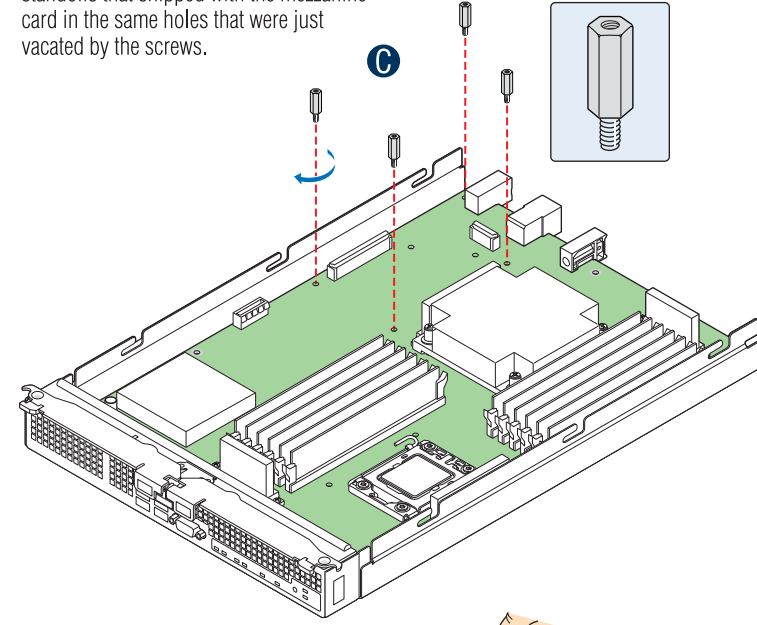

- D** Position the mezzanine card above the mezzanine card connectors on the server board and align the four holes with the standoffs. Carefully press the mezzanine card into place until it is fully seated in the connectors and resting on the standoff supports.

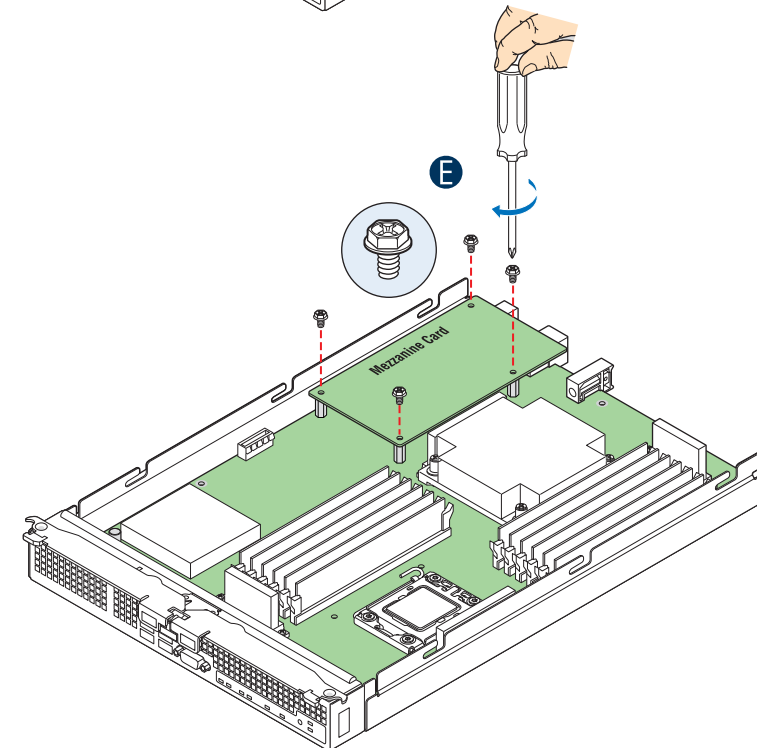

- E** Secure mezzanine card to standoffs with the four screws previously removed.

9 Install Processor Air Duct

Install processor air duct as shown.

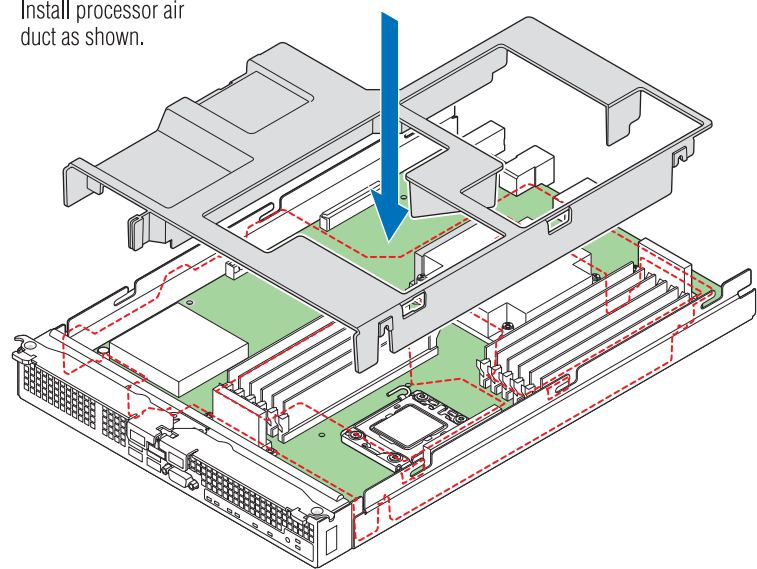

10 Install Top Cover

- A** Align top cover over corresponding notches in module chassis.
- B** Slide top cover forward to close.

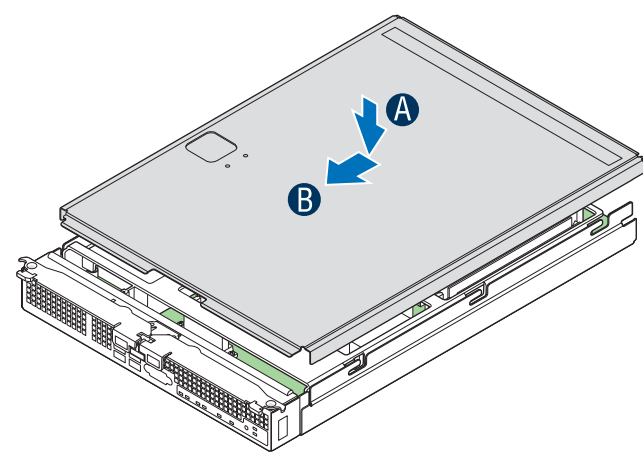

Front Panel Connectors and Indicators

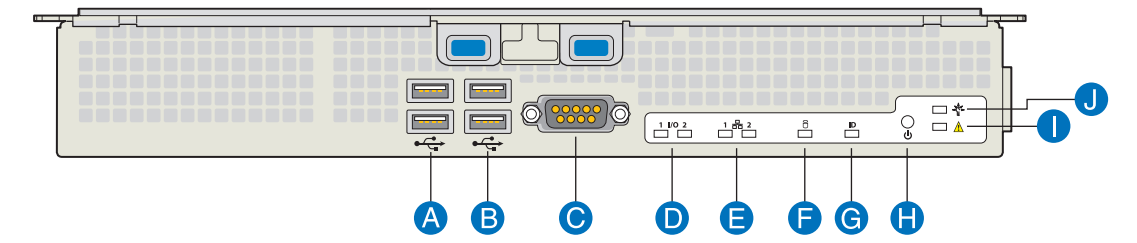

- A. USB Ports 0 and 1
- B. USB Ports 2 and 3
- C. Video Port
- D. I/O 1 and I/O 2 Activity LEDs
- E. NIC1 and NIC2 Activity LEDs
- F. Disk Activity LED
- G. ID LED
- H. Power Button
- I. Fault LED
- J. Power LED

Component Layout

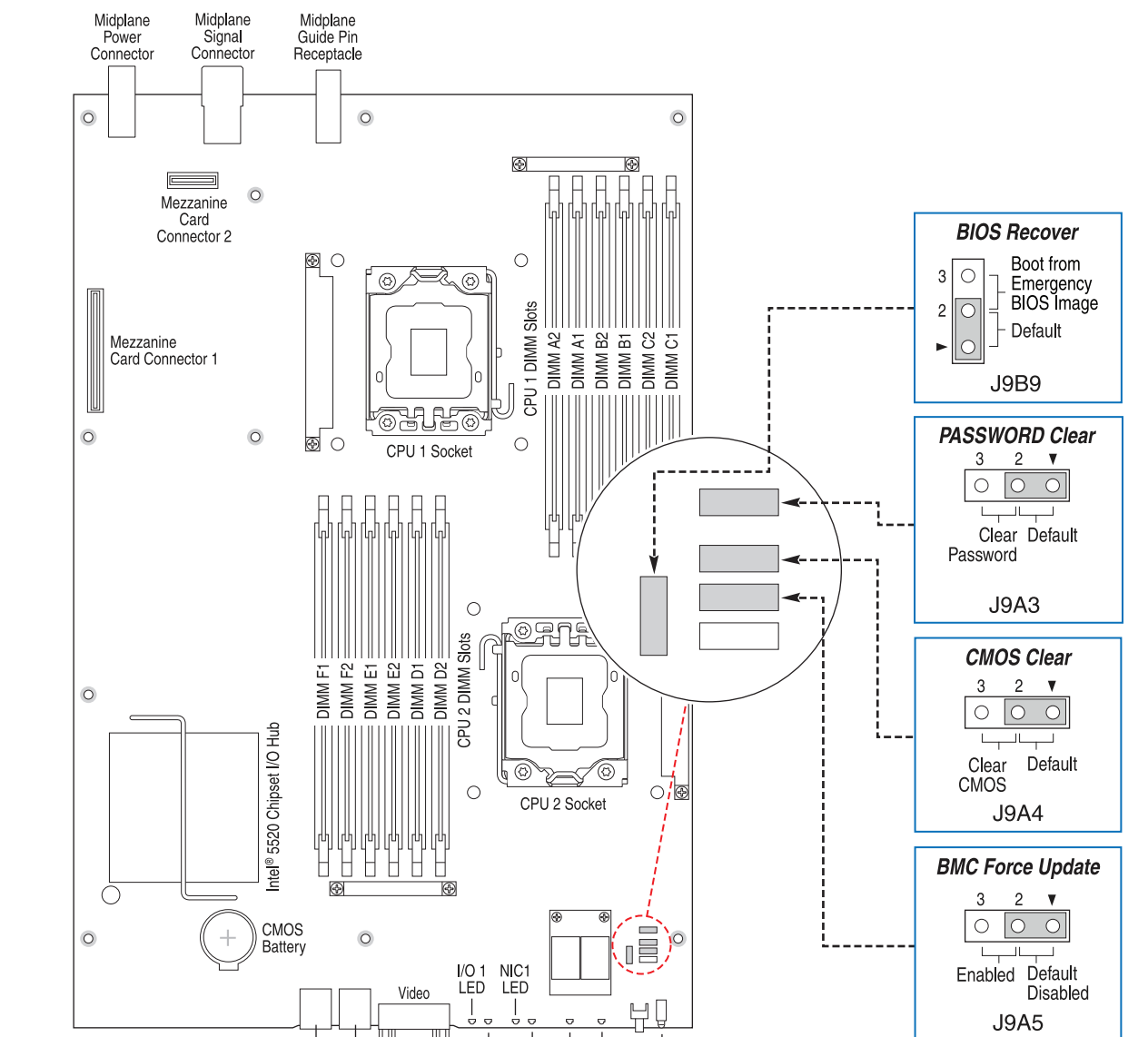

See your Intel® Compute Module MFS520V1 User Guide for expanded component and connection information.

CAUTION
Risk of explosion if battery is replaced with an incorrect type. Batteries should be recycled where possible. Disposal of used batteries must be in accordance with local environmental regulations.

Diagnostic LED Information

LED Name	Function	Color	Indicator
Power LED	Identifies power state of compute module	Green	Off = Power off On = Power on Slow blink = Standby or sleep mode
Fault LED	Identifies fault warning	Amber	Off = No fault On = Critical error or non-recoverable Slow blink = Non-critical Fast blink = Locate (when device does not have an ID LED) Double blink = Degraded state
ID LED	Identifies compute module	Blue	Use Intel® Modular Server Control UI to turn ID LED on or off
Drive Activity LED	Indicates drive activity	Green	Off = No drive activity Blink = Drive activity
NIC1-NIC2 Activity LEDs	Indicates network activity and link	Green	Blink = Outbound Activity
I/O 1 and I/O 2 Activity LEDs	Indicates network activity and link of NICs on mezzanine card	Green	Off = No link On = Link established Blink = Activity